

BEGA**33 567**

Lichtbaustein®

 IP 44

Project · Reference number

Date

Product data sheet

Application

Lichtbaustein® The cube
Ceiling and wall luminaire with hand-blown satin
matt three-ply opal glass.
For a variety of interior and exterior lighting
applications.

Product description

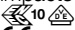
Luminaire made of aluminium alloy
and stainless steel
BEGA Unidure® coating technology
Opal glass satin matt
2 mounting holes \varnothing 5 mm
Distance apart 70 mm
1 cable entry for mains supply cable
up to \varnothing 10,5 mm
2 prefabricated cable ducts for surface
mounted mains supply cables \varnothing 7–10,5 mm
Lampholder terminal 2.5[□]
Earth conductor connection
Lampholder E 27
Safety class I
Protection class IP 44
Protected against granular foreign bodies
 \geq 1 mm and splash water
Impact strength IK03
Protection against mechanical
impacts < 0.35 joule
 – Safety mark
CE – Conformity mark
Weight: 2.2 kg

Lamp

Luminaire with screw base E 27
Lamp output max. 75 W
This product contains light source of energy
efficiency class E

Supplied lamp

BEGA LED lamp **13588**
LED Retrofit 8 W · 1055 lm · 3000 K

Luminaire efficiency: 80%

Additional BEGA LED lamps are available for
this luminaire:

13584 LED 7 W · 805 lm · 3000 K
13586 LED 7 W · 805 lm · 3000 K
dimmielable
13590 LED 12 W · 1400 lm · 3000 K
13592 LED 12 W · 1400 lm · 3000 K
dimmielable

Detailed technical and lighting data for the
lamps can be found in the data sheets on our
website.

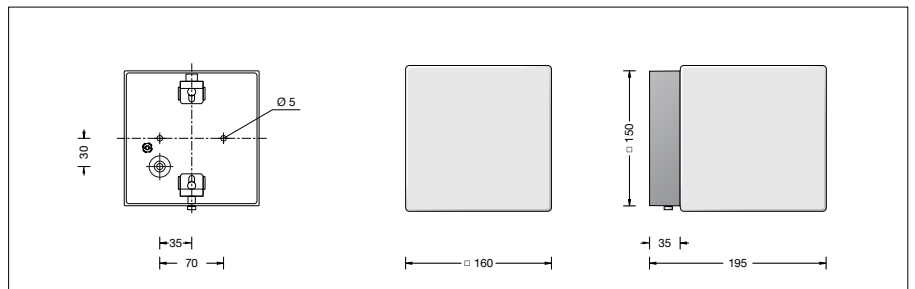
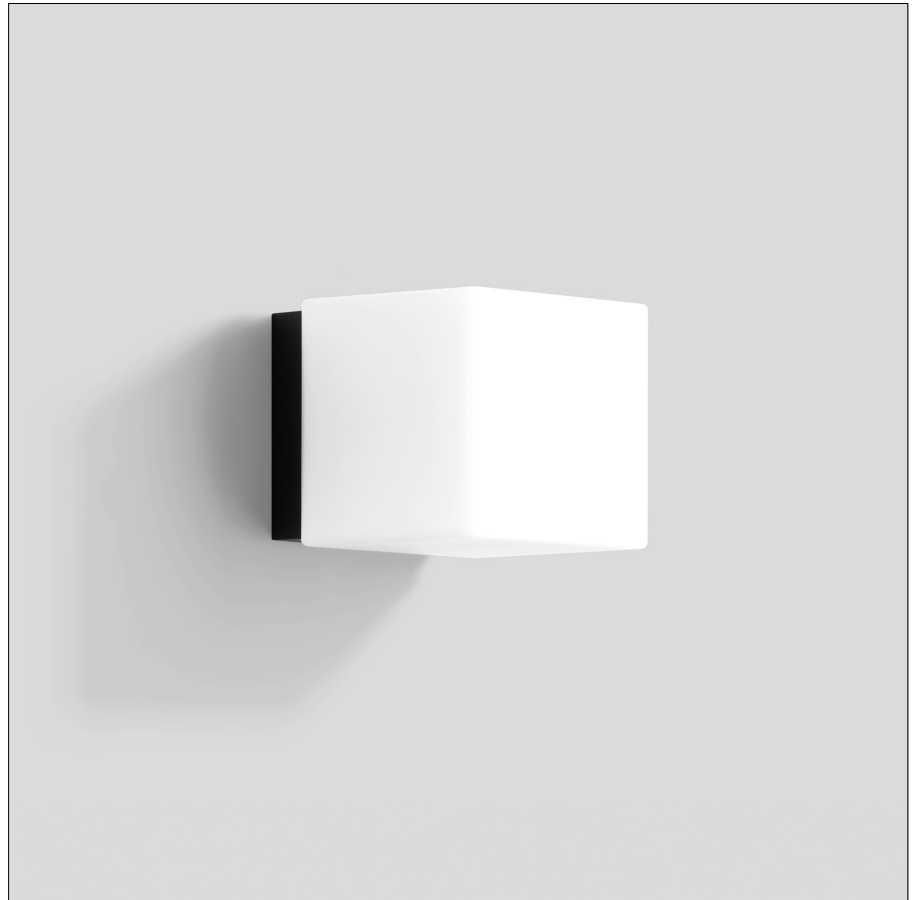

Lighting technology

Luminaire data for the DIALux lighting design
program for outdoor lighting, street lighting
and indoor lighting, as well as luminaire data in
EULUMDAT and IES format are available on the
BEGA website at www.bega.com.

Ratio of luminous flux

Luminous flux upper half-space 40,3 %
Luminous flux lower half-space 59,7 %

BUG rating according to IES TM-15-07:
0–3–1

CEN Flux Code according to EN 13032-2:
25–52–77–60–81–14–39–68–40

Light distribution

